

Introduction

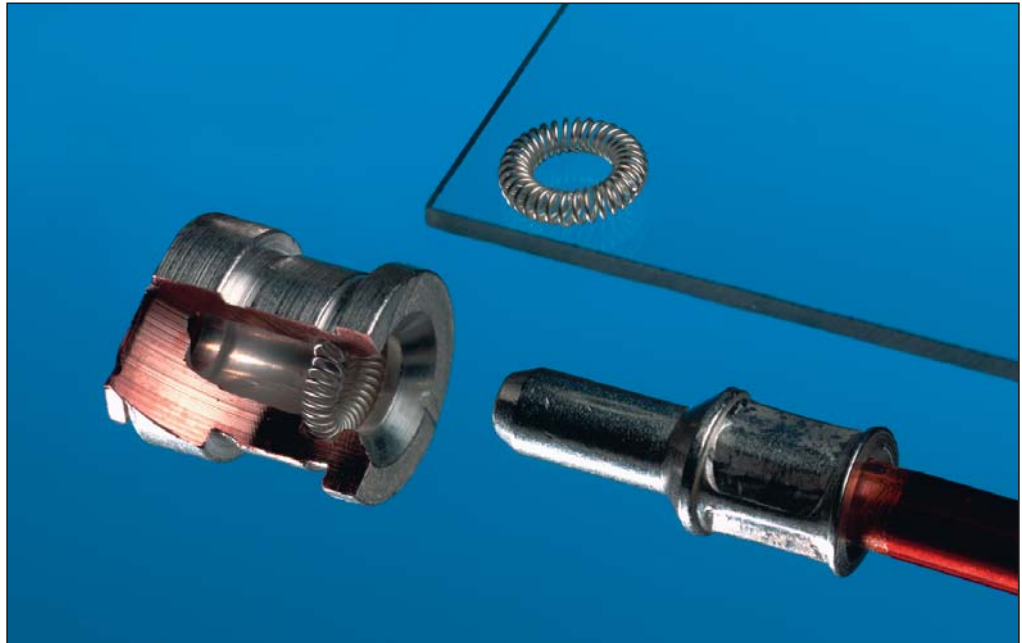

**Silver Plated Power Contacts with Contact Springs for Maximum Performance in Exposed Applications**



The demand for shortest possible periods of machine shut-downs and assembly times requires the use of connectors at the interfaces of the connector wires, as well as energy feeding and power circuits. To satisfy the demand of the various applications the series Power Connector was designed.

On the basis of the standard series HSB.6/35 (power supply up to 35 A, 6 poles) the development and the elaboration of this series is being continued rigorously as a result, almost any application up to current of 2,000 A can be realized by using a series of different power contacts.

Due to the modular structure the different varieties of customer requirements in this sector can be met. We also offer solutions for your application specific requirements.

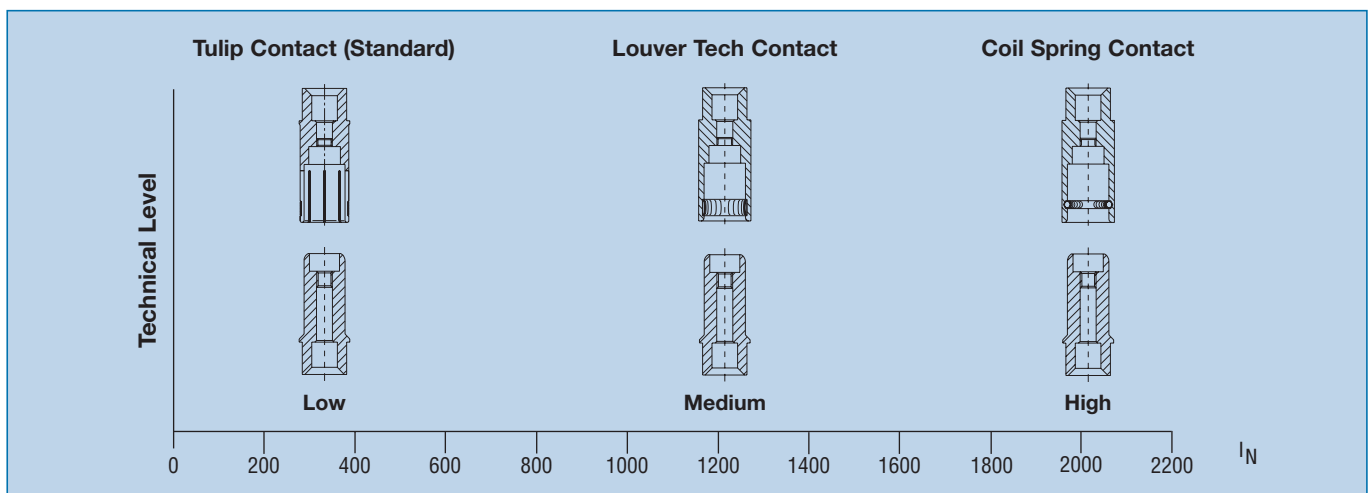

Coil Spring Power Contact

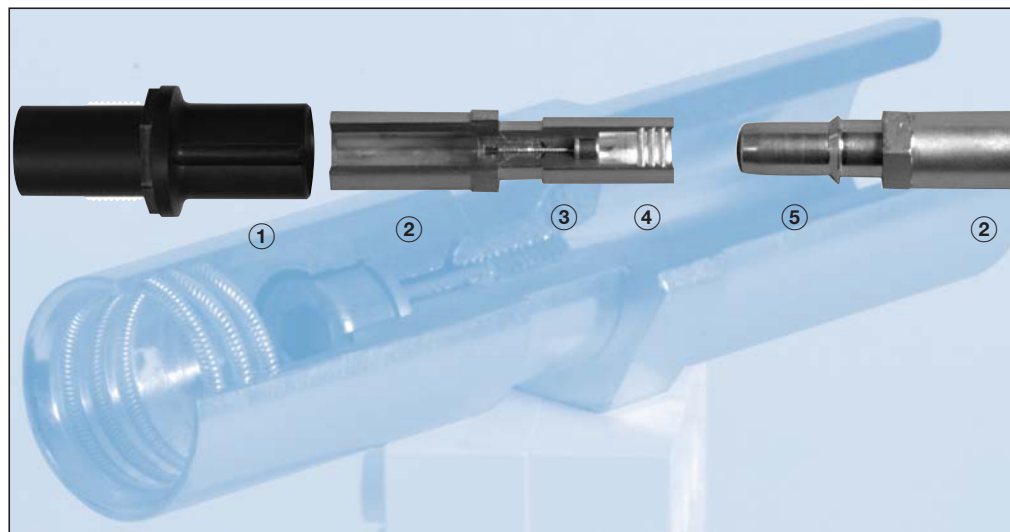

**Coil Spring Power Contact**



- ① Insulating Material Plastic
- ② Crimp Ferrule
- ③ Female Contact
- ④ Coil Spring
- ⑤ Male Contact

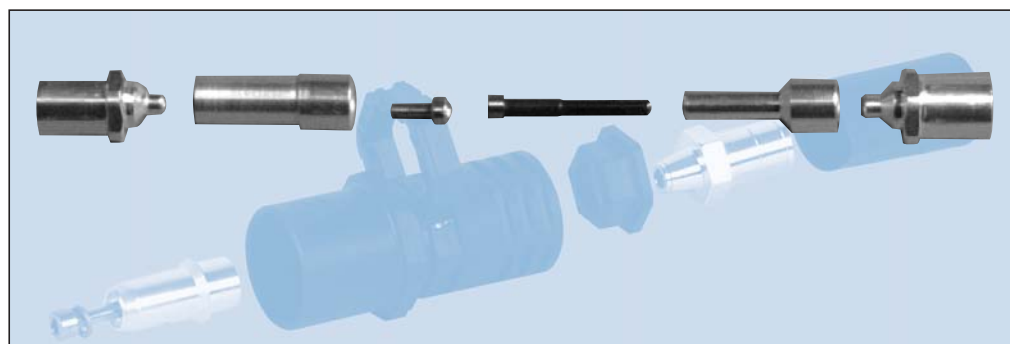

**② Crimp Ferrule**

- Optimum material adaptation acc. to customer's application
- Adaptation to special customer wire size and crimping tools
- Same crimp ferrule for male, female and grounding contact
- Robust crimp ferrule for tough applications

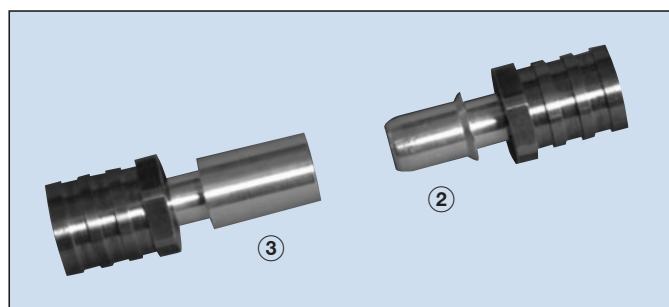

**② Male Contact**

**③ Female Contact**

- Wear-resistant basic material
- Worn parts can be individually exchanged
- Surface coating according to customer application
- Reduced mating and pulling forces
- Vibration test
- High current capability through many contact points
- Variable wire termination

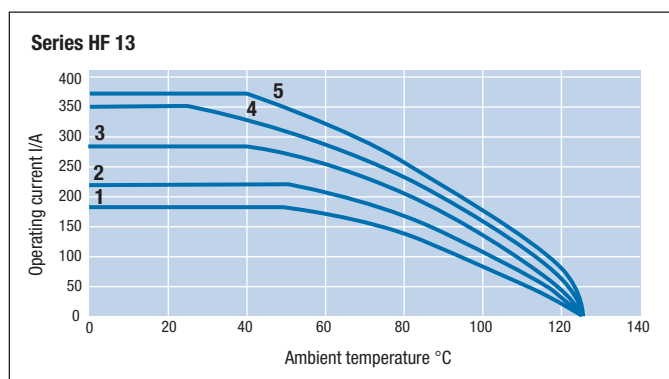

**Derating Diagram**

- Curve 1 = 35 mm<sup>2</sup>
- Curve 2 = 50 mm<sup>2</sup>
- Curve 3 = 70 mm<sup>2</sup>
- Curve 4 = 95 mm<sup>2</sup>
- Curve 5 = 105 mm<sup>2</sup>

## HF-8 Module

### HF-8 Module

Size 8

No. of Contacts

4

1000 V/250 A

IP 20

#### Male Insert incl. Pin Contact

#### Female Insert incl. Socket



Designation	Part Numbers	
	Male Insert	Female Insert
SET-HF.8Sti-Eins	1103039-1	–
SET-HF.8Bu-Eins	–	1103040-1

#### Crimp Ferrules for Pin or Socket



HF.06-CH-06 mm <sup>2</sup> -SW17	1110952-1
HF.06-CH-10 mm <sup>2</sup> -SW17	1110952-2
HF.06-CH-16 mm <sup>2</sup> -SW17	1110952-3
HF.06-CH-25 mm <sup>2</sup> -SW17	1110952-5
HF.06-CH-35 mm <sup>2</sup> -SW17	1110952-7
HF.06-CH-50 mm <sup>2</sup> -SW17	1110952-9
HF.06-CH-70 mm <sup>2</sup> -SW17	1-1110952-0
HF.06-CH-120 mm <sup>2</sup> -SW17	1103043-1*

\*) Please contact us.  
Special Hoods are requested when Voltage Rate 1000 V is needed.

#### Adapter Plates



4 x Power Contacts  
to be Mounted in  
HF-8 Hood or Housing

	Top	Bottom
HF.8.4xHF.8.O	1103035-2	–
HF.8.4xHF.8.U	–	1103035-1

#### Male Contact

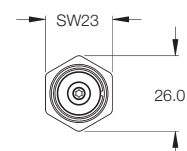
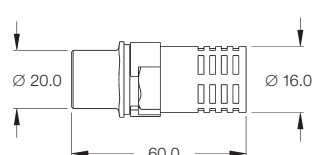
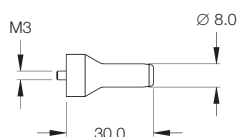

#### Female Contact

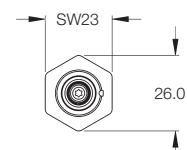
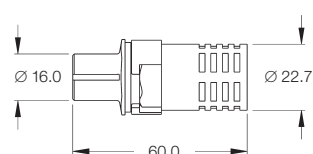
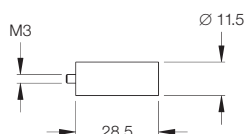

## HF-13 Module

### HF-13 Module

Size 8/12

No. of Contacts

2 + 1; 4 + 1 + 

3 kV/350 A

#### Male Insert

#### Female Insert



Contact  
for Power



Contact  
for Grounding



3 x for Power  
1 x for Earth  
1 x for Signal (HA.10)  
Assembly in HF.12 Housings

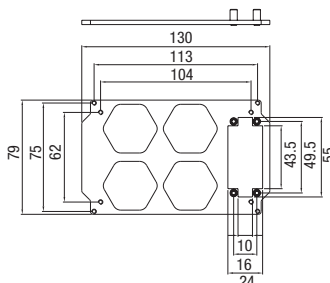

HF.12.3+PE+BG2

Top

Bottom

1110955-3

1110955-1



3 x for Power  
1 x for Earth  
1 x for Signal (HE.6)  
Assembly in HF.12 Housings

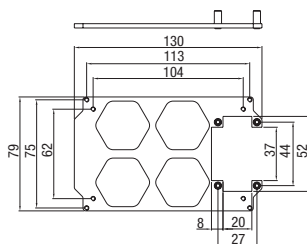

HF.12.3+PE+BG3

1110955-4

1110955-2



2 x for Power  
1 x Signal  
Assembly in HF.8 Housings

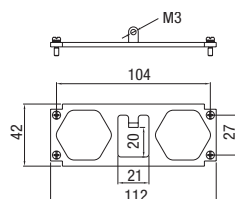

HF.8.2+BG1

1110960-2

1110960-1\*

HF.8.2+BG1

–

1110960-3\*\*

\*) For Bottom Housing with 81 mm Height  
\*\*) For Bottom Housing with 20 mm Height

## Crimping Sleeves

### Crimping Sleeves

max. 150 A

#### Crimping Sleeves for Contact Series HF-08

Crimp Barrel for Pin/Socket Side

- Shrink Tube
- Crimp Barrel



Designation	Part Number
CH.06mm <sup>2</sup> -SW17	1110952-1
CH.10mm <sup>2</sup> -SW17	1110952-2
CH.16mm <sup>2</sup> -SW17	1110952-3
CH.25mm <sup>2</sup> -SW17	1110952-5
CH.35mm <sup>2</sup> -SW17	1110952-7
CH.50mm <sup>2</sup> -SW17	1110952-9
CH.70mm <sup>2</sup> -SW17	1-1110952-0

### Crimping Sleeves

max. 350 A

#### Crimping Sleeves for Contact Series HF-13

Crimp Barrel for Pin/Socket Side

- Shrink Tube
- Crimp Barrel
- Adapter



Designation	Part Number
CH.50mm <sup>2</sup> -13/16mm	1110953-5
CH.70mm <sup>2</sup> -13/16mm	1110953-6
CH.95mm <sup>2</sup> -13/16mm	1110953-7
CH.105mm <sup>2</sup> -13/16mm	1110953-8
CH.120mm <sup>2</sup> -13/16mm	1110953-9
CH.150mm <sup>2</sup> -13/16mm	1-1110953-1

## Housings

### HF-HIP-K 8/HF-EMV-K 8 HF-HIP-K 12/HF-EMV-K 12 Housings

Size 8/12

EMV: Protection against electro-magnetic interference, pressure-tight, Housings corrosion-resistant, black

HIP-K: Housings corrosion-resistant, black

#### Screw Lock on Hood

IP 68

#### Hood

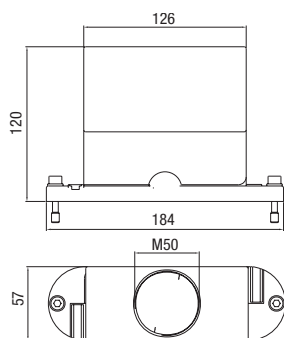

Metric	PG	Designation	Part Number
1xM50		HF-HIP-K.8.Sto.1.M50G	1102839-4
1xM50		HF.8.EMV-K.8.Sto.1.M50G	1102839-3
2xM40		HF.HIP-K.8.Sto.2.M40G	1102839-2
2xM40		HF.EMV-K.8.Sto.2.M40G	1102839-1

#### Housing Bottom

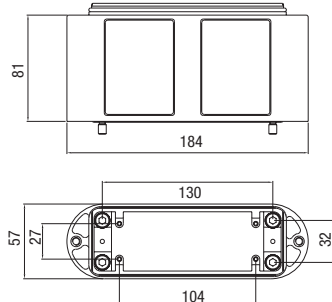

Height			
20 mm		HF-HIP-K.8.AG.N	1102837-2
20 mm		HF-EMV-K.8.AG.N	1102837-1
81 mm		HF-HIP-K.8.AG	1102836-2
81 mm		HF-EMV-K.8.AG	1102836-1

#### Hood

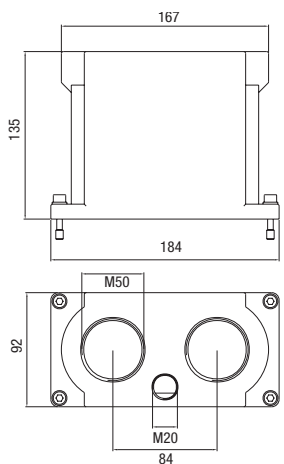

2xM40		HF-HIP-K.12.Sto.2.M40G	1102840-2
2xM40		HF-EMV-K.12.Sto.2.M40G	1102840-1
2xM50		HF-HIP-K.12.Sto.2.M50G	1102840-4
2xM50		HF-EMV-K.12.Sto.2.M50G	1102840-3

#### Housing Bottom

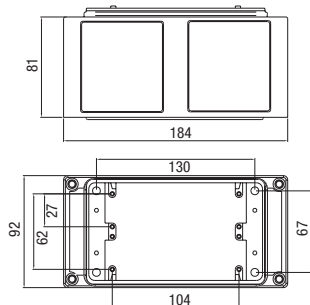

Height			
20 mm		HF-HIP-K.12.AG.N	1102838-2
20 mm		HF-EMV-K.12.AG.N	1102838-1
81 mm		HF-HIP-K.12.AG	1102192-2
81 mm		HF-EMV-K.12.AG	1102192-1